

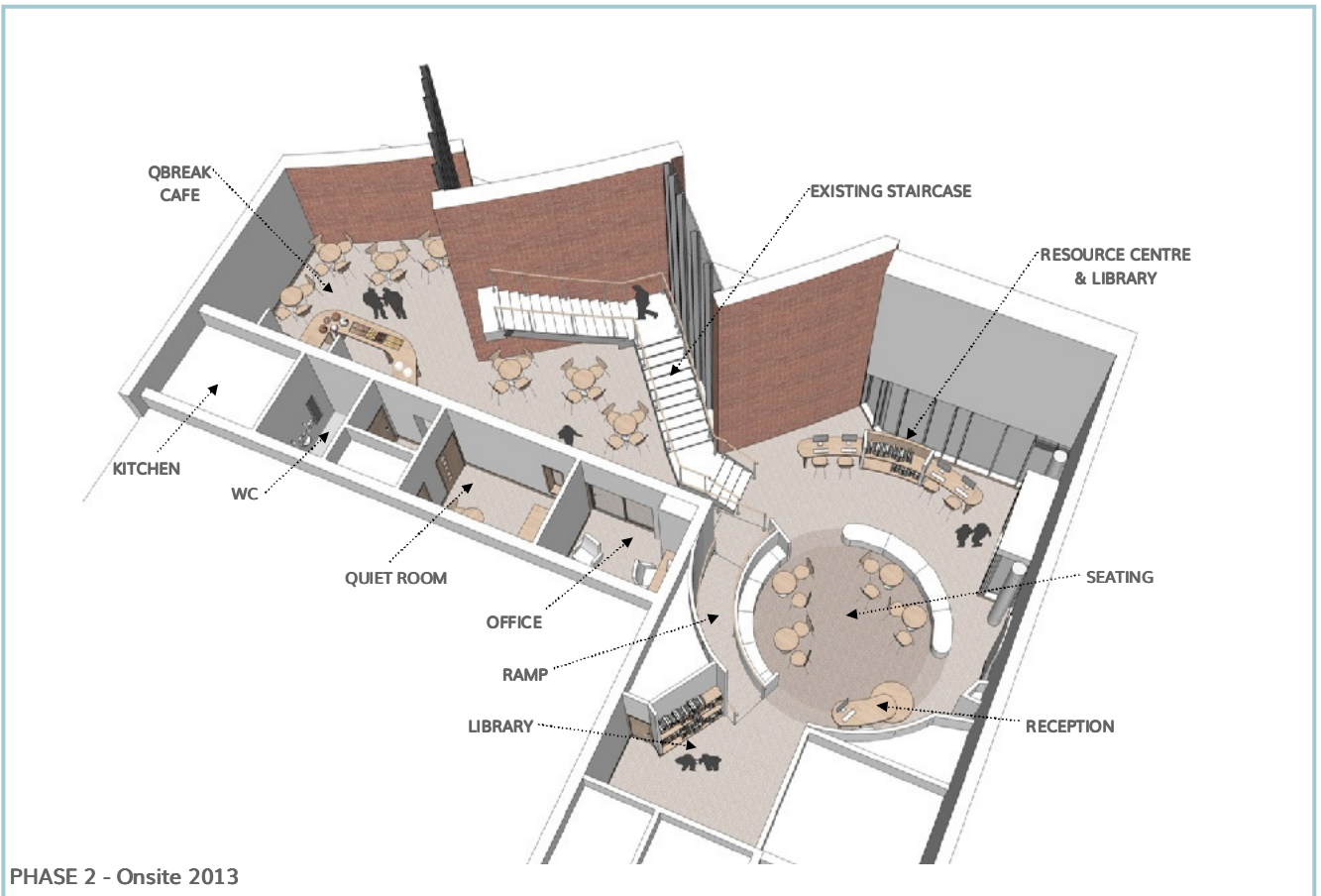

CASE STUDY: COMMUNITY
QUAKER MEETING HOUSE LIVERPOOL



PHASE 1 - Completed 2006



PHASE 2 - Onsite 2013



Design Strategy

The new building was designed in partnership with architects Page and Park of Glasgow who devised the building shell, with the interior design being completed by Ainsley Gommon.

During Phase 1 Ainsley Gommon looked to design a interior of simple character and calmness that would not only create an appropriate space for Quaker worship but also provide a wide range of uses for other partners who share the building. This includes conference facilities and space to accommodate music examinations.

Phase 2 involved making the entrance area inclusive and inviting to the public regardless of faith. This is being achieved by opening up a series of rooms into one large open space which will encompass a cafe, resource library and informal seating area. Ancillary spaces off the main space include an office, kitchen, WC and multi-faith contemplation room.

Sustainability Overview

Phase 2

- All materials specified are 100% recyclable and many are recycled.
- Existing elements such as the lobby screen and ramp balustrading have been re-used.
- Fitting thermostatic radiator valves and efficient new fan connector heaters in the main spaces to improve energy efficiency
- Installing energy and water saving taps and valves to basins and dual flush toilets
- Fitting occupancy controlled energy efficient PIR lighting to WCs and a new efficient control system to the main hall ventilation system

CASE STUDY: COMMUNITY QUAKER MEETING HOUSE

Name of Building

Quaker Meeting House

Building Type

Place of Worship

Location

Liverpool City Centre

Client

Liverpool Quaker Meeting

Main Contractor

Melwood Construction Ltd



Phase 1 - Original Meeting House

Date Completed

May 2006

Project Cost

£2.75 million

Phase 2 - Alterations to Reception

Date Onsite

July 2013

Project Cost

£164,000

Building Overview

The original Liverpool Quaker Meeting House reached Practical Completion in 2006 ahead of Liverpool's Capital of Culture celebrations. Ainsley Gommon have since been asked to design alternations to the reception area.

The building is a key part of Grosvenor's Paradise Street Redevelopment Area and provides a bespoke £ 2.75 million design next to Bluecoat Chambers in the heart of Liverpool city centre.

The new building was designed in partnership with architects Page and Park of Glasgow who devised the building shell, with the interior design being completed by Ainsley Gommon.

The building is linked to the BBC TV and Radio Studios. It formed an important part of the city's regeneration in advance of the 2008 European Capital of Culture celebrations and Ainsley Gommon acted for Friends in their negotiations with the scheme developers, facilitating Liverpool One.

Ainsley Gommon worked very closely with Liverpool's Quaker Community and Grosvenor to design an interior of simple character and calm. This would not only create an appropriate space for worship but also a wide range of uses for other partners who share the facilities including conference facilities and music examinations. A high degree of acoustic control and flexibility was needed to respond to the diverse range of uses and Ove Arup assisted with specialist engineering and services consultancy.

In 2012 Ainsley Gommon produced a design for improvements to the reception area. The aim being to open up the existing rooms into a friendly open space which will give the Friends a new resource centre, library and cafe.

