

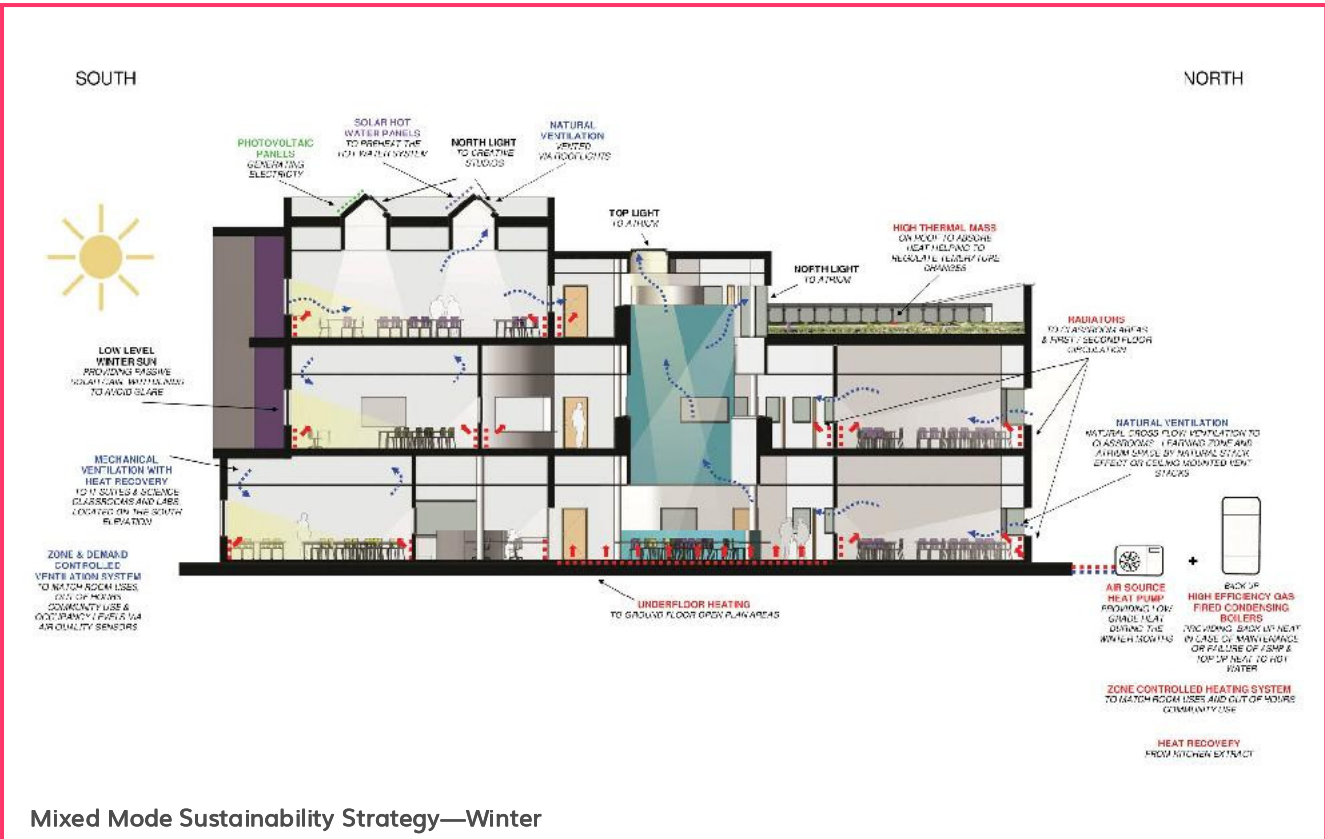

CASE STUDY: **EDUCATION**

'DEESIDE 6' POST 16 EDUCATION CENTRE



Mixed Mode Sustainability Strategy—Winter





Design Approach

Conceptually, the building form consists of two regular wings of teaching accommodation, orientated to work with the site boundaries and contours, which are placed at an angle to create a tapering centralised space which reflects footfall and internal circulation. The rear block is a regular three storey block providing specialised teaching space, performance and lecture rooms, and studio accommodation. The scale and modelling of this rear block has been designed to respond sympathetically with the adjacent Connah's Quay High School buildings with which it has a direct visual relationship. The remaining teaching accommodation is located within a two storey block to the front of the building. This largely accommodates general teaching classrooms which are flexible, naturally lit and naturally ventilated. On the ground floor this block also accommodates the Dining Area, which projects forward from the regular form of the teaching block, allowing a physical break and strong visual link to be made with the building entrance and approaches. As the north block is at a lower level to the main core

and rear block, this presents opportunities to create roof garden areas and elevated terraces, adding to external recreational space on offer to students and facilitating high level views across the Dee Estuary, main campus and open fields to the North-West.

The tapering core space between the two teaching blocks is split into three main areas. The front area this acts like a 'lantern' entrance space, drawing in the visitor on approach and highly visible from a distance. This large 'front of house' space will act as the main social hub space full of student activity. As the core space tapers in plan, this leads to centralised areas of unsupervised study space on multiple floors. This space is naturally lit from above though an atrium space, which is largely north lit via a long strip of glazing which looks out over the second floor roof garden area.

The use of high quality insulated metal cladding and colour as a design tool were seen by the design team as a simple and cost effective approach well suited to the locale and key to achieving a vibrant learning experience.

CASE STUDY: EDUCATION

'DEESIDE 6' POST 16 EDUCATION CENTRE

Name of Building

'Deeside 6' Post 16 Education Centre

Project Dates

2013—2016

Project Cost

Approx £14 million

Building Type

Education—Post 16

Location

Connah's Quay, Flintshire

Client

Coleg Cambria & Flintshire County Council

Contractor

Wynne Construction

Building Overview

'Deeside 6' has been jointly developed by Coleg Cambria and Flintshire County Council to provide state-of-the-art facilities and a broader curriculum choice for up to 16-19 learners. Providing an inspirational learning experience for 700 students in a centralised location between Coleg Cambria's Deeside Campus and Connah's Quay High School, the completed building includes specialist Performing Arts, Music, Science and Creative Arts facilities as well as general teaching classrooms and social and private study spaces. Accessed from a newly formed entrance from Golftyn Lane, the scheme includes staff and visitor car parking for the new Centre as well as a coach park to serve the wider Coleg Cambria campus. The highly sustainable building exceeds the BREEAM Excellent standard, capturing copious amounts of daylight and natural ventilation while utilising a number of sustainable technologies including air source heat pumps, photovoltaic cells and solar hot water panels.

Ainsley Gommon Architects were first appointed by Coleg Cambria in September 2013 and worked closely with the College's commissioning team to define the initial accommodation requirements and Client aspirations. A detailed design was then developed involving full consultation with all stakeholders. Due to a very tight programme to secure funding, a planning application was submitted three and a half months later. The scheme received planning consent in April 2014 and AG|A were then appointed to provide a technical design package, specification and room data sheets to allow the scheme to be tendered. Following the appointment of the Main Contractor, AG|A were retained by Coleg Cambria to act as Client Advisor, overseeing the Contractor's Design Proposals to ensure the technical compliance and fulfilment of the brief.

AG|A were separately appointed to undertake the Interior Design of the new building, working closely with the College to choose colours, finishes, branding and signage proposals. In addition, all landscaping design was undertaken by our in-house Landscape Architect.

