

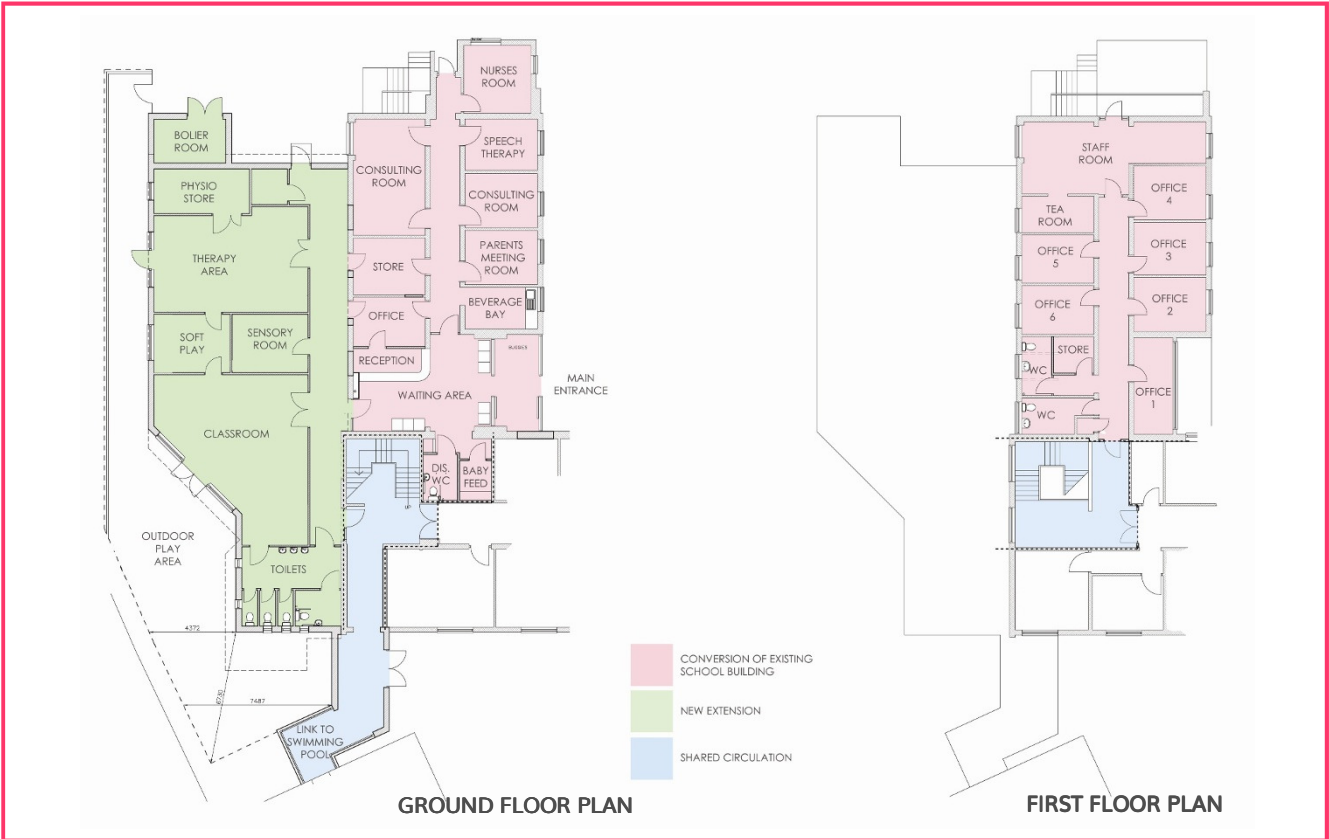

CASE STUDY: EDUCATION  
CONWY CHILD DEVELOPMENT CENTRE





---

## Designing for Complex Needs

The Conwy Child Development Centre provides services base for pre-school children with neurodevelopmental problems, long term physical illness and disabilities.

Designed to create a non-clinical setting, the Centre is intended to make children and families feel at ease, providing an accessible environment, whilst maintaining adequate security for the children.

Within the building, the facilities provided cater for a variety of developmental needs. A classroom provides a more conventional learning environment, but is supplemented by a soft play room and a sensory room to promote learning through play, stimulating the senses and promoting feelings of wellbeing.

The classroom allows direct access out into an external Play Area which has a resilient safety surface and is enclosed by a hoop topped railings to ensure the safety and security of the children.

Medical and nursing facilities are also provided and include a variety of consulting and therapy rooms. The building is designed to be easily recognisable and navigated, with the ancillary office accommodation located on the first floor, out of the way of the visiting children.

Internally, colours, finishes, seating, lighting and artwork have all been chosen to help children feel at ease within the building, creating a 'home from home' atmosphere. This approach is continued into the parents meeting room, providing a room that replicates a normal domestic living room with facilities to listen to music and watch television.

The building has good levels of natural light achieved through large windows and rooflights. Illuminated coloured art boxes are located within the ceiling in the corridor spaces to provide visual stimulation for the children.

---

---

# CASE STUDY: EDUCATION

## CONWY CHILD DEVELOPMENT CENTRE

---

**Name of Building**

Conwy Child Development Centre  
Ysgol Gogarth

**Date Completed**

December 2008

**Project Cost**

£720,000

**Building Type**

Education

**Location**

Llandudno, Conwy

**Client**

Betsi Cadwaladr University Health Board  
and Conwy County Borough Council

**Main Contractor**

Peter T. Griffiths Ltd

**Building Overview**

Conwy Child Development Centre provides specialist facilities for young children aged from 0-5 years who have disabilities and complex developmental difficulties. Located on the site of Ysgol Gogarth, a special needs school providing day and residential education for children in Llandudno, the project was a joint development between Conwy County Borough Council and Betsi Cadwaladr University Health Board.

The centre makes use of a vacant two storey former residential block at the easternmost wing of the existing school building, undergoing a programme of internal remodelling to provide a variety of educational, therapy, medical, nursing and ancillary office accommodation.

The single storey extension has been designed to allow an upper storey to be added should there be a need for future expansion. The building was specially designed to be child friendly, with large windows allowing excellent levels of daylight into the spaces, located at a level low enough to allow the children to see views out over the surrounding landscape. The facilities included within the Centre include a classroom, specialist therapy rooms, consulting rooms and a parents meeting room.

The existing school is a diverse collection of buildings constructed from a variety of materials. The design of the new Centre keeps to one external material, an off-white render, intended to create a sense of calm to the new addition, whilst providing an uplifting bright clean finish. This is complimented with the use of a signature blue colour, used to highlight entrances and windows and in the external safety surfacing, distinguishing the Child Development Centre from the other buildings on the site.

